

„ Music was my first love. And it will be my last.
Music of the future. And music of the past.“ John Miles

WHD



A-line

AURAL PLEASURE

LOUDSPEAKERS AND AUDIO SYSTEMS
FOR THE DISCERNING LISTENER.

Sound solutions for living rooms. For private and commercial buildings.

The essence of music is to give joy. Aristotle (384–322 B.C.)

ENJOY MUSIC IN THE BEST QUALITY. WHY SHOULD YOU AC

The sensitivity of our ears is so great that we miss almost nothing; we could actually hear grass growing. There are good reasons for this, for in primitive times our hearing warned us of approaching dangers. Therefore, we cannot shut our ears like we can shut our eyes.

And yet sometimes we would like to do precisely this: day in and day out, we are surrounded by voices, whistling, humming, squeaking and buzzing from countless sources of sound. This acoustic stress can potentially be harmful to health. And it ensures that we can lose our desire to hear well.

CEPT ANY LESS?



Where language ceases, music begins. ETA Hoffmann (1776–1822)

THE BEST IN LISTENING PLEASURE.

For over 75 years, we at WHD have been working on providing our customers only the best when it comes to listening pleasure. It's no wonder that we are one of the world's leading suppliers of top quality loudspeakers and multiroom systems. Designing and realizing interiors is something that our attractive and design-oriented speakers are made for: they match the architecture and interior layouts of living spaces.

After all, the essence of music is to give joy. You shouldn't accept any less.



DESIGN



AESTHETICS

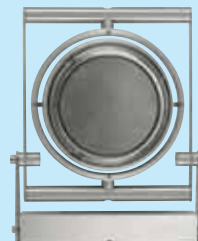

FUNCTION



CONTENTS

MUSIC IN ALL ROOMS

P 6-9 MULTIROOM

CEILING SPEAKERS

P 10-11 R 240

P 12-13 M 240

P 14-15 UP 14/2
UP 14/2-8 STEREO
UP 14/2 MARINE

P 16-17 UP 26

P 18-19 UP 40

P 20-21 KEL

P 22-23 HLS 51

P 24-25 KLS 111

WALL SPEAKERS

P 26-27 WL 6/2

P 28-29 WL 10/2
WL 8/2

P 30-31 WL 10/2 LED

P 32-33 MINI 4
MICRO 2

P 34-35 SUB 200

HANGING SPEAKERS

P 38-39 KL 1603/2 C

P 40-41 KL 1900 WG

P 42-43 RLS 166/2

OUTDOOR SPEAKERS

P 46-47 SL 25/2

P 48-49 R 1900 WPL

Music is often not perceived as beautiful because it is associated with noise. Wilhelm Busch (1832–1908)

BEING FREE MEANS BEING ABLE TO CHOOSE: THE MULTIROOM MUSIC EXPERIENCE.

The famous creator of Max and Moritz would not have written this sentence if he had been able to enjoy a WHD audio multiroom system. With these systems, you can fill all rooms with sound and enjoy music independently of your cohabitants. Thus, for example, you can devote your attention to the Brahms piano concerto in G-minor while your son enjoys Rolling Stones, your daughter listens to Mariah Carey and your wife swoons to André Rieu. Or if you'd prefer things the other way around, no problem; WHD's audio multiroom systems can do all this and more.

How does it work? It's easy! Four things characterize your music experience with audio multiroom systems: the best sound, easy operation, beautiful design and great pleasure. You'll be pleased, for example, when you select your favorite song right from the bathtub. In order to offer you the perfect audio multiroom experience, you can choose from among three systems.

With the completely digital DAM 6000 audio multiroom system, you control the sound source with a remote control or small, stylish control panels in each room. The SSC 430 audio distributor, by contrast, is the easy and inexpensive solution for filling several rooms with sound simultaneously. The SSC 430 is optionally available for use with either one or two hi-fi systems. With the EIB/KNX audio system, you select not just the hi-fi device, but also the volume and sound in each room individually. With the same user interface, you can switch the lights on and off, operate the sun-blinds, the heat, the alarm system and much more.

Multiroom systems from WHD provide you with a total audio experience. If you have any questions, we would be glad to answer them for you.



DAM 6000 DIGITAL AUDIO MULTIROOM SYSTEM

SSC 430 AUDIO DISTRIBUTOR

MULTIROOM

EIB/KNX AUDIO MULTIROOM SYSTEM



DAM 6000

Decentralized control of:

- Volume
- Power
- Sound source
- Sound equalisation (bass, mid-range, treble)
- Operation of the sound sources (play, skip, ...) via the control panels or remote control

Possibilities

- 6 sound sources can be connected to the central unit
- 4 sound sources in the rooms can be connected in the rooms
- 254 independent sound zones can be realized

EIB/KNX Audio System

Decentralized control of:

- Volume, Power
- Sound source selection
- Sound equalisation (bass, mid-range, treble)
- Microphone announcements

Possibilities

- Up to 8 sound sources
- Up to 4 sound zones per audio device.

For a larger number of rooms, the devices can be cascaded.



SSC 430

Central operation for each room individually:

- Volume, Power
- Sound source A or B

Possibilities

- Max. 4 rooms in stereo



EXAMPLE OF USE OF MULTIROOM SYSTEM



WELCOME TO THE SPA AT HOME.

Other people have to leave the house for a wellness experience - you simply go into the bathroom. Treat yourself to a pleasant bath and relax with your favourite music. You can select this quite simply by remote control.

Want to change the volume and the tone? Here too pushing a button is all it takes.

MUSICAL ENJOYMENT NOW COMES AT THE PUSH OF A BUTTON.

With the DAM system you can distribute music to rooms and adjust the volume individually for each listening situation. Just by the push of a button. If you plug in the headphones, the loudspeakers are automatically switched off. If only everything in life were so simple.



EVERYONE HAS HIS OWN WISHES – EVERYONE HAS THEM FULFILLED.

That's how it is in a household: many people like to listen to music – many do not. It's perfect – with the DAM system you can make everybody happy. At the push of a button you can cut off rooms and just as simply add them in again. You can do this with the control elements in the room itself, or by remote control.

COMPLETELY RELAXED, EVEN IF THINGS NEED TO GO A BIT FASTER.

Did you know that? Sometimes you need to hurry a little, and then it is necessary to push dozens of buttons and not forget any. The DAM system works quite differently. You switch it off, and back on again, with one press of a button, because we are totally committed to your convenience. The solution: small, nifty controls which get by with four buttons: loud / quiet, on / off, sound source selection, title selection. All other functions are regulated with your remote control and of course also by the push of a button.



Harmony speaks for itself. Yehudi Menuhin (1916–1999)

THE R 240. A LOUDSPEAKER AS IT SHOULD BE: COMPLETE PERFECTION.



How do you build the perfect loudspeaker? You take the technical abilities of the M 240: the premium sound; a multi-flexible and adaptable design allowing you to personalize its appearance. And then you ensure a harmonious finish. The new R 240 can do everything its square brother can. The only difference is its beautiful round shape. Its flexibility is proven by the wide selection of frames you can choose from: the R 240 is available in white glass, green glass or black glass, high-grade steel or East African Wenge wood. You could even choose a gyp-

sum screen, which you can paint any colour you desire. And because the R 240's harmonious round shape also suits plastered walls, the on-wall housing is available as standard in white, anthracite or any other RAL colour you specify.



White glass



Green glass



Black glass



High-grade steel



Wenge wood finish



Gypsum

TECHNICAL DETAILS

Load rating/music power

Impedance

Frequency range (-10 dB)

SPL 1W/1m

Material

Cut out

Colour

Weight

Field of application

Accessories

Versions

R 240

40/50 W

8 Ohm

50-22,000 Hz

89 dB

white glass, green glass, black glass, high-grade steel, Wenge wood finish or gypsum, grille and on-wall housing: metal, rear baffle: plastic

ø 214 mm

grille: white or anthracite (see above), on-wall housing: white or anthracite

2 kg

indoor

on-wall housing AG R 240

100V/6W, 100V/25W



R 240

In-wall

On-wall

AG R 240

R 240

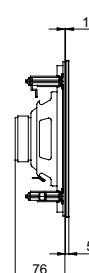
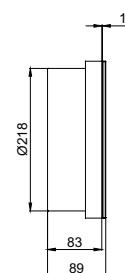
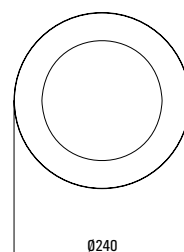

Music expresses that which cannot be said and that which it is impossible to leave unsaid.

Victor Hugo (1802–1885)

THE M 240. BECAUSE WE LIVE IN TIMES IN WHICH FLEXIBILITY IS REQUIRED OF EVERYTHING, EVEN OF LOUDSPEAKERS.



The freedom to which we allude applies to the M 240, the multi-flexible design loudspeaker for in-wall and on-wall installation. With its compact dimensions of 240 mm x 240 mm, it sounds just like a premium loudspeaker should sound. And it's as flexible as they come; with the M 240 you can choose from a wide selection of frames to personalise its appearance. Design the features yourself: choose from white glass, green glass or black glass, high-grade steel or East African Wenge wood finishes. You could even choose a gypsum screen, which

you can paint any colour you desire. A loudspeaker can't be any more flexible than the M 240, and because we are bound to this principle, we can offer its on-wall housing in any RAL colour you choose.



White glass



Green glass



Black glass

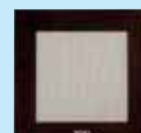

Wenge wood finish



High-grade steel



High-grade steel,
polished



Gypsum



Gypsum
with metal grille

TECHNICAL DETAILS

Load rating/music power

Impedance

Frequency range (-10 dB)

SPL 1W/1m

Material

Cut out

Colour

Weight

Field of application

Accessories

Versions

M 240

40/50 W

8 Ohm

50-22,000 Hz

89 dB

white glass, green glass, black glass, high-grade steel, Wenge wood finish or gypsum, grille: metal, on-wall housing: plastic

□ 225 mm

grille: white or anthracite (see above), on-wall housing: white or anthracite

2.2 kg

indoor

on-wall housing AG 240

100V/6W, 100V/25W

M 240

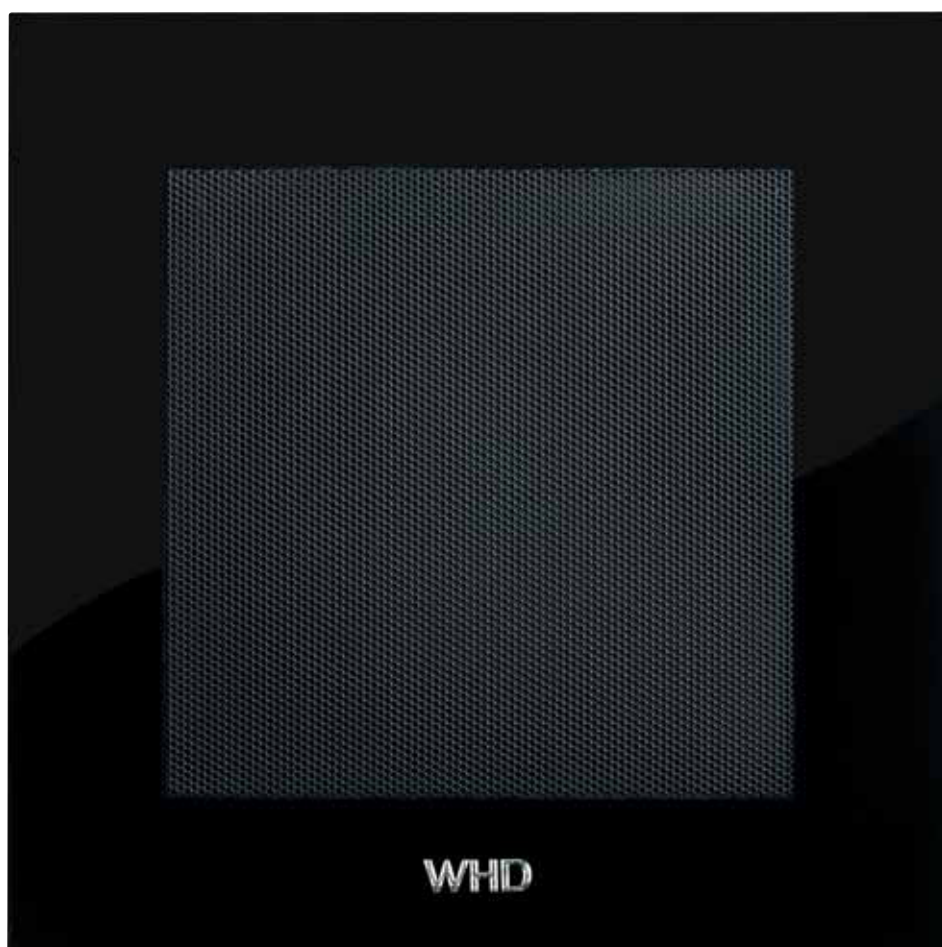

Innovationspreis
Architektur und Technik

In-wall

On-wall

AG 240

M 240

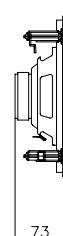
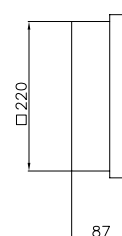
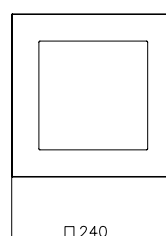

It's not necessary to understand music, you only need to enjoy it. Leopold Stokowski (1822–1977)

THE UP 14/2. THE UP 14/2 MARINE. THE UP 14/2-8 STEREO. FOR DESIGN FANS. FOR BEACH BOYS. FOR WEST END GIRLS.



The UP 14/2. A built-in hi-fi loudspeaker for high-quality background music in living spaces.

The UP 14/2 is one of our most versatile loudspeakers, both in form and in how and where it can be used. The UP 14/2 is available in square and round versions. As we like to say, enjoy your music whenever and wherever you wish. The UP 14/2 is the ideal loudspeaker for anyone who wants to combine beautiful design with practical functionality.

The UP 14/2 stereo. A single loudspeaker, but stereo nevertheless.

Don't small apartments have a right to big sound? Of course they do! For rooms that are too small for two loudspeakers, there are two possibilities: the narrow version with just one channel or the clever version with the UP 14/2-8 stereo. With the UP 14/2-8, both stereo channels come from one loudspeaker, with no loss of audio performance, all presented in typical WHD sound quality.

The UP 14/2 Marine. Who says that water and loudspeakers don't mix?

We recommend the UP 14/2 Marine for outdoor areas and humid rooms. By manufacturing the speaker with protected magnets, woofers with polypropylene membranes and steel cover plates, the UP 14/2 is designed to withstand all manner of harsh conditions. And it plays Wolfgang Amadeus Mozart just as well as Deep Purple. When will you throw your next pool party?

TECHNICAL DETAILS

Load rating/music power
Impedance
Frequency range (-10 dB)
SPL 1W/1m
Material
Cut out
Colour
Weight
Field of application
Versions

UP 14/2 (Q)

40/50 W
8 Ohm
50-22,000 Hz
89 dB
plastic speaker and mounting ring, metal grille
ø 180 mm/ □ 188 mm (Q)
white RAL 9016, other colours possible
1.2 kg
indoor
100V/6W, 100V/25W, active versions -

UP 14/2 (Q) Stereo

25/40 W
2 x 8 Ohm
40-26,000 Hz
86 dB
ø 180 mm/ □ 188 mm (Q)
1.2 kg
indoor

UP 14/2 Marine

25/40 W
4 Ohm
60-22,000 Hz
87 dB
ø 180 mm
1.2 kg
in- and outdoor
100V/6W, 100V/25W

UP 14/2

UP 14/2-8 STEREO

UP 14/2 MARINE



UP 14/2

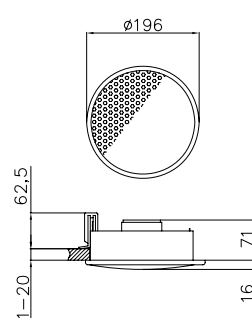

UP 14/2 Q

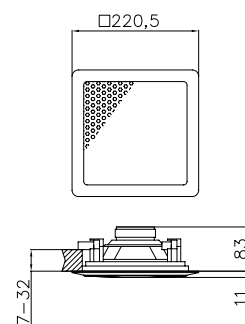

Only music is the world language and doesn't need to be translated.

Berthold Auerbach (1812–1882)

THE UP 26. FOR THE DISCERNING LISTENER.

THE UP 26.

FOR THE DISCERNING LISTENER.

Our UP 26 built-in hi-fi loudspeaker is easy to describe: it offers you the very best sound in a beautiful package. It's no wonder that the UP 26 is at home wherever shapely architecture meets good taste. On request, a subwoofer version is also available. Combined with smaller WHD built-in loudspeakers, you can conjure a sound that will turn your rooms into concert halls.

The opinion of the trade press: "In all disciplines, the UP 26 has the stuff to be a good hi-fi loudspeaker that wins you over with its level stability, easy installation and reasonable price...a true recommendation." PROFESSIONAL SYSTEM 6/2001

TECHNICAL DETAILS

Load rating/music power

Impedance

Frequency range (-10 dB)

SPL 1W/1m

Material

Cut out

Colour

Weight

Field of application

Versions

UP 26

40/50 W

4 Ohm

35-22,000 Hz

91 dB

speaker and mounting ring plastic, metal grille

ø 230 mm

white RAL 9016, other colours possible

1.6 kg

indoor

100V/6W, 100V/25W

UP 26

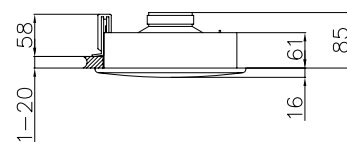
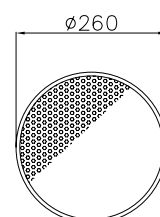

Music is the language of passion. Richard Wagner (1813–1883)

WITH THE UP 40, PARCIVAL SOUNDS JUST AS GOOD AS STRAWBERRY FIELDS.



How did Oscar Wilde put it? My taste is very simple – the best of everything. When it comes to music, you should share this opinion, for often enough we are confronted with poor sound. With the UP 40 2-way built-in hi-fi loudspeaker, you don't have to worry; it guarantees you the best sound with the best appearance. But what if you have concrete ceilings? On request you can get the appropriate in-wall housing for your UP 40. That way, it doesn't matter under what kind of ceiling you enjoy Richard Wagner today and the Beatles tomorrow: the sound experience is always unique.

The opinion of the trade press: "From the point of view of a neutral and high-quality playback, especially for music the UP 40 should be your absolute first choice...pleasing in this context is its relatively reasonable price." PROFESSIONAL SYSTEM 6/2001

TECHNICAL DETAILS

Load rating/music power	UP 40 40/60 W
Impedance	8 Ohm
Frequency range (-10 dB)	40-21,000 Hz
SPL 1W/1m	86 dB
Material	plastic frame, aluminium grille
Cut out	275 x 189 mm
Colour	white RAL 9016, other colours possible
Weight	2.0 kg
Field of application	indoor
Versions	100V/6W, 100V/25W

UP 40

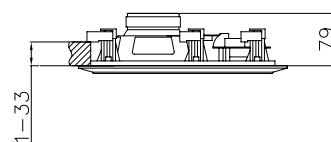
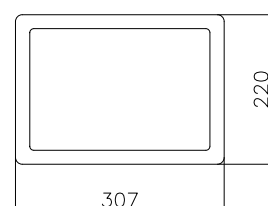

Music and rhythm find their way to the soul's most secret places. Plato (427–347 B.C.)

KEL – DO YOU KNOW OF ANOTHER GOOD LOUD-SPEAKER THAT WILL FIT IN A SWITCHBOX?



As the saying goes – small is beautiful. With KEL, we have designed a loudspeaker which is compact enough to fit into all common switch programmes but with a big enough sound for everyone!

Available in a range of different colours and fitted with a humidity-proof loudspeaker membrane, KEL is perfect for use anywhere in your home.

TECHNICAL DETAILS

Load rating/music power

Impedance

Frequency range (-10 dB)

SPL 1W/1m

Material

Cut out

Colour

Weight

Field of application

Versions

KEL

30 W (PMPO)

8 Ohm

100-21,000 Hz

83 dB

metal grille

ø 56 mm

white, anthracite, silver, other colours possible

0.15 kg

indoor

20 Ohm, 100V/3W

KEL



Delivery without frame

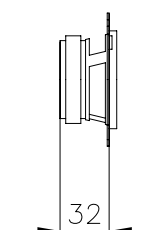
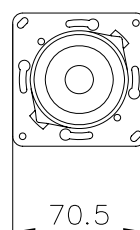

Music is the best form of communication. Angelo Branduardi (* 1950)

LET THERE BE LIGHT! LET THERE BE MUSIC! WITH THE HLS 51, BOTH ARE POSSIBLE.



Keep your music source hidden with the new HLS 51 design loudspeaker. With a diameter of only 51 mm, this new speaker looks and fits like a typical halogen spotlight, but supplies a sound which belies its size. In combination with the WHD UP 14 SUB, outstanding audio is available in all types of rooms.

TECHNICAL DETAILS

Load rating/music power
Impedance
Frequency range (-10 dB)
SPL 1W/1m
Material
Colour
Weight
Field of application
Accessories

HLS 51
30 W (PMPO)
20 Ohm
150-20,000 Hz
82 dB
metal housing and grille, delivery without frame
white RAL 9016, chrome, other colours possible
0.06 kg
indoor
Subwoofer UP 14 SUB

HLS 51



Delivery without frame

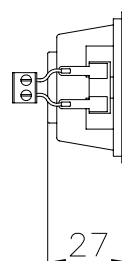
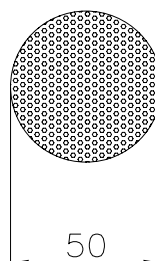
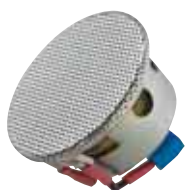

The best thing about music is not the notes. Gustav Mahler (1860–1911)

WITH THE KLS 111, THE KARDAN LOUDSPEAKER, YOU COMBINE LIGHT AND MUSIC IN SYMBIOSIS.



The KLS 111 is the ultimate loudspeaker for playing background music in living spaces. Combine it with any standard 111 mm Kardan light and the appropriate WHD subwoofer and you have a high quality speaker system which can pivot in any direction. Light and sound have never been so attractive.



KLS 111

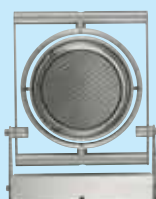

KLS 111-AP



KLS 111-TS



KLS 111-UP

TECHNICAL DETAILS

Load rating/music power

Impedance

Frequency range (-10 dB)

SPL 1W/1m

Material

Cut out

Colour

Weight

Field of application

Accessories

Versions

KLS 111 (-AP, -UP)

40 W (PMPO)

20 Ohm

80-21,000 Hz

86 dB

metal housing and grille

198 x 190 mm (UP)

chrome/high-grade steel

1.0 kg (AP), 2.1 kg (UP)

indoor

Subwoofer UP 14 SUB, UP 26 SUB

100V/6W

KLS 111-TS

4 x 40 W (PMPO)

4 x 20 Ohm

80-21,000 Hz

86 dB

metal housing and grille

chrome/high-grade steel

3.7 kg

indoor

Subwoofer UP 14 SUB, UP 26 SUB

100V/6W



KLS 111

KLS 111-AP

KLS 111-TS

KLS 111-UP

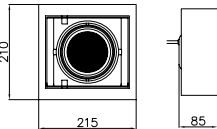
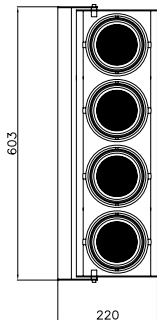
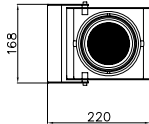

The folds of all worries fall away as long as the magic of the song reigns. Friedrich von Schiller (1759–1805)

FLEXIBLE AND FUNCTIONAL – WITH THE WL 6/2 YOU DECIDE THE MUSIC SOURCE.



With an attractive, sleek and modern design, the WL 6/2 wall speaker combines fantastic sound with functional choice. Using the optional integrated volume controls and program select switch, you can decide on which of up to 6 connected music sources you listen to at any time.

TECHNICAL DETAILS

Load rating/music power
Impedance
Frequency range (-10 dB)
SPL 1W/1m
Material
Colour
Weight
Field of application
Accessories
Versions

WL 6/2
25/40 W
8 Ohm
80-25,000 Hz
89 dB
plastic housing, metal grille
white RAL 9016, silver RAL 9006, other colours possible
1.3 kg
indoor
Subwoofer SUB 200
with integrated volume control and/or programme selection
100V/10W, 100V/25W, active version



Pictured in white

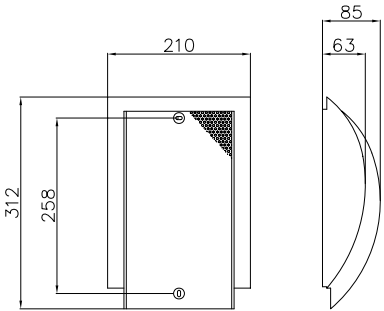

Without music, life would be a mistake. Friedrich Nietzsche (1844–1900)

THE WL 10/2: AT LAST A LOUDSPEAKER THAT FULFILLS ALL REQUIREMENTS.



Blending sophisticated design with incredible sound, the WL 10/2 is the product of choice when you need a speaker to be all things to all men. Featuring attractive steel covers, the WL 10/2 merges effortlessly into any room and supplies audio quality which can win over any listener.

THE WL 8/2: THE LITTLE BROTHER WITH THE BIG SOUND.



With its smaller dimensions, the WL 8/2 can be used anywhere where there is less space available. However, when it comes to sound, it is every bit the equal of the WL 10/2.

TECHNICAL DETAILS

Load rating/music power

Impedance

Frequency range (-10 dB)

SPL 1W/1m

Material

Colour

Weight

Field of application

Accessories

Versions

WL 10/2

25/40 W

8 Ohm

60-25,000 Hz

89 dB

metal housing and grille

white RAL 9016, silver RAL 9006

2.3 kg

indoor

Subwoofer SUB 200

100V/12W, active version

WL 8/2

25/30 W

8 Ohm

80-22,000 Hz

85 dB

metal housing and grille

white RAL 9016, silver RAL 9006

2.2 kg

indoor

Subwoofer SUB 200

100V/6W

WL 10/2

WL 8/2



WL 8/2

WL 10/2

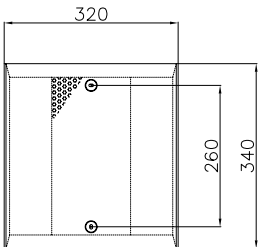
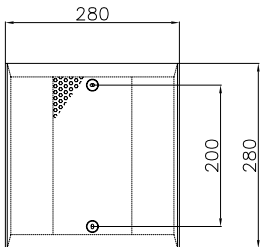

Music is the complete type of art: it never gives away its last secret. Oscar Wilde (1854–1900)

THE WL 10/2 LED. WHERE MUSIC AND LIGHT COMBINE IN HARMONY.

Whether playing music in a wellness area, hotel lobby or at home, the WL 10/2 LED combines the beauty of sound and light in one elegant package. Calming built-in LEDs change colour at speeds you control, according to your mood. With a slim housing, the WL 10/2 LED is attractive and unobtrusive wherever you choose to mount it.



TECHNICAL DETAILS

Load rating/music power
Impedance
Frequency range (-10 dB)
SPL 1W/1m
Material
Colour
Weight
Field of application
Accessories
Versions

WL 10/2 LED

25/40 W
 8 Ohm
 60-25,000 Hz
 89 dB
 metal housing and grille
 silver RAL 9006
 3.0 kg
 indoor
 Subwoofer SUB 200
 100V/12W, active version

WL 10/2 LED

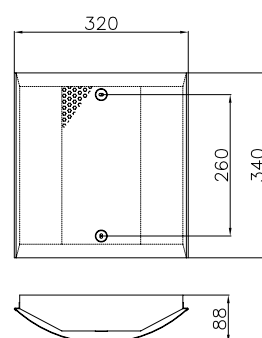
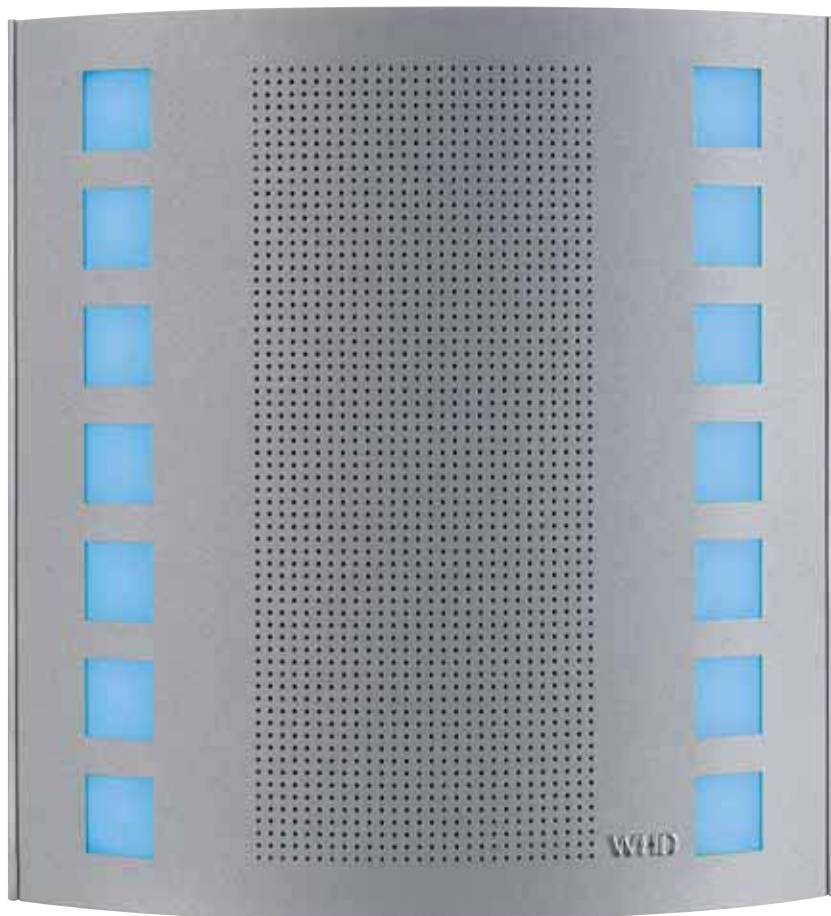

Without music, everything would be nothing. Wolfgang Amadeus Mozart (1756–1791)

THE MINI 4 HI-FI BOX. THE PROOF THAT LESS IS MORE.



Who said that big sound has to come from big boxes? The Mini 4 loudspeaker packs plenty of sonic punch from a compact package. With advanced bass reflex technology and high quality tweeters, the Mini 4 can be mounted in a variety of areas and deliver all the sound you need.

THE MICRO 2. SMALL JUST GOT SMALLER.



The 2-way Micro 2 hi-fi box wins over its fans with its extremely compact dimensions and astonishingly luscious sound. Small box, good sound – ears, what more do you want?

TECHNICAL DETAILS

Load rating/music power
Impedance

Frequency range (-10 dB)
SPL 1W/1m

Material
Colour

Weight
Field of application
Accessories

Versions

Mini 4

50/70 W
8 Ohm

70-23,000 Hz
88 dB

plastic housing, metal grille
white RAL 9016, silver RAL 9006,
black RAL 9005

1.5 kg
indoor
ball joint mounting (WHMini)
u-type bracket (WBMini)
Subwoofer SUB 200
100V/30W, outdoor version

Micro 2

10/15 W
8 Ohm

120-22,000 Hz
86 dB

plastic housing, metal grille
white RAL 9003, silver RAL 9006,
black RAL 9004

0.8 kg
indoor
incl. wall mounting
Subwoofer SUB 200

100V/6W

MINI 4

MICRO 2



Pictured in white

Pictured in black

Mini 4

Micro 2

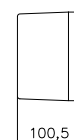
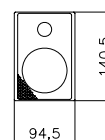
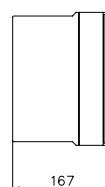
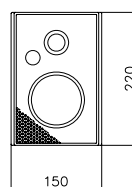

For 30 years, I've been having a wild affair with a woman named rock and roll. Billy Joel (* 1945)

THE SUB 200 SUBWOOFER. COULD YOU TURN UP THE BASS A LITTLE?



A clear case: if the music in question is rock and roll, a good subwoofer is required. But it's not just when the electric guitar is making sparks fly that you'll be glad to have it, for the SUB 200 subwoofer ensures impulse-accurate replay and loudspeaker adjustment between it and the satellites. Thus, you can use it everywhere where you want to support the sound of your WHD design loudspeaker in the bass range, regardless of whether you're playing Billy Joel or Ludwig van Beethoven.

TECHNICAL DETAILS

Load rating/music power
Impedance
Frequency range (-10 dB)
SPL 1W/1m
Material
Colour
Weight
Field of application
Accessories

SUB 200
2 x 50 W
2 x 8 Ohm
40-150 Hz
88 dB
chipboard housing, inlaid
white, black
10.1 kg
indoor
WHD Design/Hi-Fi loudspeaker

SUB 200



Pictured in white

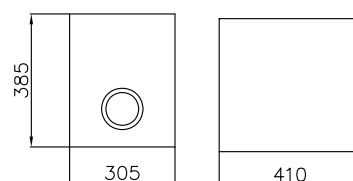





GOOD HEARING ISN'T SO EASY.

If you have always wanted to know how hearing works, then listen up: first there are the sound waves of a sound which reach our outer ear. From there, they travel through the ear canal to the eardrum and set this little membrane vibrating. Behind it are the bones which help us hear; these have funny names like hammer, anvil and stirrup, and they are the smallest bones in the human body, but they do great things: they sense the eardrum vibrations and pass them along to the inner ear. The inner ear is filled with fluid in which the travelling wave forms. It excites a membrane and the hair cells associated with it. From here, what you hear is conducted to the brain by a nerve impulse. Only there can you actually hear the sound for the first time.

This sounds complicated, and it is. No wonder, for as the saying goes: "The eye brings the person into the world, but the ear brings the world to the person." And it's also no wonder that we at WHD do everything so that this complex hearing process is supplied with only the most pleasant sounds.

Music is the key to the heart. Johann Gottfried Seume (1763–1810)

THE KL 1603/2 C HI-FI HANGING LOUDSPEAKER: SINCE HIGH ROOMS REQUIRE A SPECIAL KIND OF LOUDSPEAKER.



Creating good sound is an art. Therefore, during filming, there are always more sound engineers on the set than camera people. And in concert halls, the technicians practice as long as the musicians do. Therefore it is good to know that with the KL 1603/2 hanging loudspeaker, you have the optimal loudspeaker for filling high rooms with sound. Whether a market hall, a shopping mall, a foyer or a villa: with hanging speakers, you bring the listener's ear to the loudspeaker, avoid reverberation and ensure

area-wide sound. Finished in chrome, the KL 1603/2 blends beautifully into all high-ceilinged areas, especially when combined with sphere lights.

TECHNICAL DETAILS

Load rating/music power
Impedance
Frequency range (-10 dB)
SPL 1W/1m
Material
Colour
Weight
Field of application
Versions

KL 1603/2 C
40/50 W
4 Ohm
50-22,000 Hz
89 dB
chromed plastic, metal grille
chrome
1.9 kg
indoor
100V/12W, 100V/25W



KL 1603/2 C

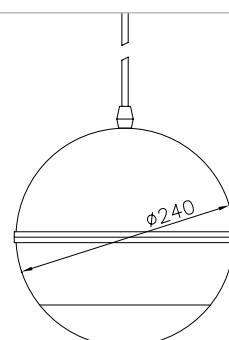

If music is the food of love, play on! William Shakespeare (1564–1616)

THE KL 1900 WG HI-FI HANGING LOUDSPEAKER. IT'S GUARANTEED NOT TO LEAVE YOU HANGING.

If your concern is good sound, our philosophy is simple: only the best for your ears. If you don't want to do without in high rooms, we recommend the KL 1900 WG hi-fi hanging speaker. Its sound fulfills the highest requirements. Four tweeters ensure a homogeneous sound, the bass reflex luscious low end. And its design is impressive, for the visible loudspeakers make an especially exciting impression in your room. In short: with the KL 1900 WG, music likes to play on, precisely as long as you'd like it to.



TECHNICAL DETAILS

Load rating/music power
Impedance
Frequency range (-10 dB)
SPL 1W/1m
Material
Colour
Weight
Field of application
Versions

KL 1900 WG
50/70 W
4 Ohm
50-22,000 Hz
88 dB
plastic
silver RAL 9006
4.5 kg
indoor
100V/12W, 100V/25W



KL 1900 WG

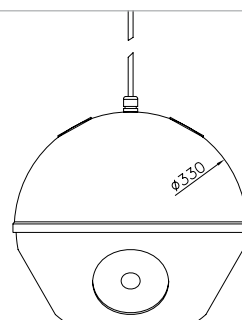

With music it's like humour: the more one hears, the finer the relationships one demands.
Georg Christoph Lichtenberg (1742–1799)

THE RLS 166/2 HI-FI LOUDSPEAKER. SOUND AND LIGHT BECOME ONE.



Regardless of whether you are trying to fill small or large rooms with sound: if they have high ceilings, we recommend our RLS 166/2 hi-fi hanging loudspeaker. Equipped with a woofer and a tweeter calotte, it ensures wonderful sound in even the most acoustically-challenging rooms. Therefore, with the RLS 166/2, even discerning listeners will say “the sky’s the limit.” Admittedly, we haven’t yet filled such a room with sound. But in any other room the RLS 166/2 will equip you with the best. Let your eyes and ears guide you...

TECHNICAL DETAILS

Load rating/music power
Impedance
Frequency range (-10 dB)
SPL 1W/1m
Material
Colour
Weight
Field of application
Versions

RLS 166/2
40/50 W
4 Ohm
50-22,000 Hz
89 dB
transparent plastic reflector, metal grille
transparent/silver RAL 9006
3.8 kg
indoor
100V/12W



RLS 166/2

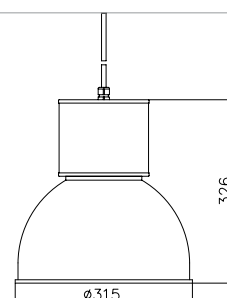



WE'RE ONLY SATISFIED IF YOU ARE.

Very few things in this world change as quickly as the world of audio technology. We can see this for ourselves when we poke around in our own product collection a little, for there is a lot to see there – and a lot more to hear. We have been dedicating ourselves to the task of creating good sound for more than 75 years and we've achieved some milestones of hi-fi and loudspeaker technology along the way.

Therefore, our principles don't include resting on our laurels. Today we're focusing intensively on design loudspeakers, innovative multiroom systems and audio electronics for switch programmes. Whatever we are developing for our customers is subject to one principle: we're only satisfied if you are.

For this reason, we pay great attention to flexibility. With our own painting plant, for

example, we guarantee your favourite colour, even in small series. For the evaluation of loudspeaker innovations, we don't rely on the formula "pi times thumbs." Instead, we rely on our in-house measuring room, whose performance cannot be matched across South Germany. And for the development of beautiful designs, our wealth of ideas knows no boundaries.

What do you get from all this? Musical pleasure that you can hear and see.



Music washes the dust of the everyday from the soul. Moses Baruch Auerbacher (1812–1882)

THE SL 25/2: WE SWEAR BY THESE HIGH-QUALITY ROCK-SOLID LOUDSPEAKERS.

And we're not the only ones: our loudspeakers are used regularly in famous places such as the Tropical Island amusement park – the largest rain forest in Europe – the Belantes amusement park and Gardaland. It's puzzling how when music plays in your garden, the source of the sound can't be detected. Or can it be that the music is coming from those stones? You've got it! We've built a first-class loudspeaker into an astonishingly natural-looking replica of granite. You can hear the result – and see it too. Furthermore, the stone loudspeaker

works at temperatures from -20° C to 60° C, so it doesn't matter whether your next garden party takes place in an equatorial or polar region.



TECHNICAL DETAILS

Load rating/music power	SL 25/2 25/40 W
Impedance	4 Ohm
Frequency range (-10 dB)	70-22,000 Hz
SPL 1W/1m	85 dB
Material	plastic housing, aluminium grille
Colour	grey, red
Weight	4.9 kg
Field of application	in- and outdoor
Versions	100V/25W



Granite red

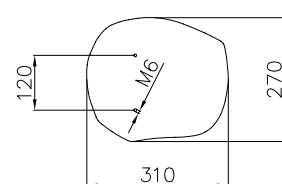

I truly believe that good music lengthens life. Yehudi Menuhin (1916–1999)

THE R 1900 WPL SPHERICAL SPEAKER: AN ALL AROUND AFFAIR!

As our customers have their standards, so have we: we wanted to develop a loudspeaker for the outdoors that looks good, sounds great, illuminates pleasantly and is completely weatherproof. Raise the curtain for the R 1900 WPL spherical loudspeaker! With it you can blast music at your party on Saturday night, enjoy classical music on Sunday morning and find your way back home at night or in foggy weather. We've even thought about anti-theft protection, so

that only you get to enjoy the benefits that the R 1900 WPL can offer.



TECHNICAL DETAILS

Lamp
Load rating/music power
Impedance
Frequency range (-10 dB)
SPL 1W/1m
Material
Colour
Weight
Field of application
Versions

R 1900 WPL
2x11 W, E27 (included in delivery)
25/40 W
4 Ohm
60-22,000 Hz
87 dB
plastic housing
frosted glass, reflector: grey
4.5 kg
outdoor, IP protection IP54
100V/25W

R 1900 WPL

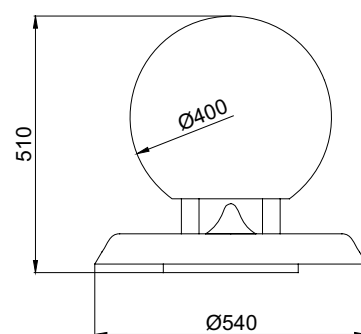



WE DON'T KNOW WHAT THE FUTURE WILL BRING OTHER THAN THE FINEST

Like you, we can't see into the future. For who would have thought in 1930 when we at WHD built our first receiver, that its successors would be digital instead of analog? Despite all the changes, there is a constant with us: technologically, we always stay ahead of the times.

Our customers know how to appreciate this. Because we don't leave the good sound to others, we work a little harder. We combine the spirit of Swabian innovation with a deep understanding of design, which is why WHD loudspeakers are found in the most famous buildings in the world: in John F. Kennedy Airport in New York and on the Sachsenring in Chemnitz. In the Duravit Design Center Hornberg, on the cruise ship Pont Aven and in the St. Francis Church in Zurich. Naturally also in recreation centres such as the Tropical Island Resort Berlin-Brandenburg

with Europe's largest rain forest. And even football fans don't have to give up good sound: many of the newest stadiums in Germany rely on sound from our company.

You profit from this: in the world of sound, experience is an important variable. This is why in the end, we will allow ourselves a view of the future; you can rely completely on our engagement when it comes to good sound today, and you will still be able to do so tomorrow.



LISTENING PLEASURE FROM OUR COMPANY.

“Music is the common language of humankind.”

Henry Wadsworth Longfellow (1807–1882)

A-Line

WHD

W. Huber + Söhne GmbH + Co.KG · Bismarckstraße 19 · D-78652 Deißlingen/Germany
Tel. + 49 (0) 74 20 / 8 89 - 0 · Fax + 49 (0) 74 20 / 8 89 - 51 · www.whd.de